



safire

VIDEO INTERCOM
2nd Generation

Video-Intercom System



Safire 2nd generation of Video-Intercom: a solution to have perfect harmony between design and innovation, with the highest efficiency in the market.

Video-Intercom System



Modularity

- ✓ Flexible Solution
- ✓ Board with different configurations
- ✓ Plug&Play modules

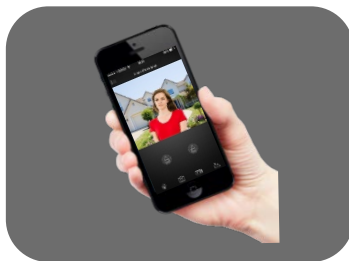

Convergence

- ✓ CCTV and Access Control
- ✓ Management from the same APP
- ✓ Safire Connect



Efficiency

- ✓ 180° fisheye image with night vision
- ✓ Monitor IPS Full Color
- ✓ Micro SD card



Flexibility

- ✓ Solution for homes
- ✓ Solution for buildings
- ✓ Embedded or surface mounted



Facilidad de uso

- ✓ Standard PoE
- ✓ Assisted configuration
- ✓ Easy and intuitive interface



Design

- ✓ Elegante y funcional
- ✓ Aviation Aluminum
- ✓ 2017 RedDot prize winner

Safire Connect APP

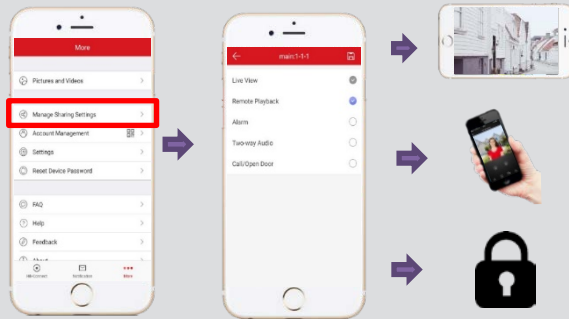

Excellent Image



180° Horizontal Vision



96° Vertical Vision



2MP Fisheye Camera

4 steps Easy Installation

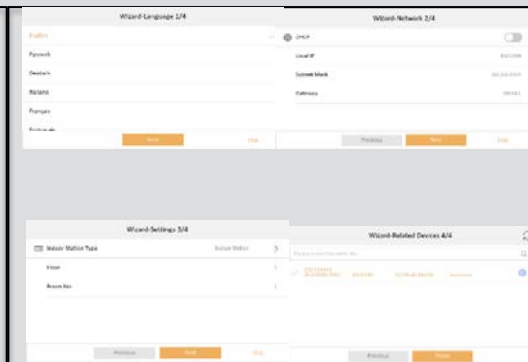

Modular Exterior Boards



Main module



Keypad module

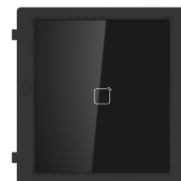

Card-reader module

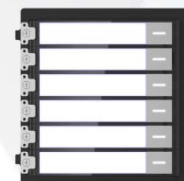

6-button module



Display module



Indicator module



Filler module

2nd generation IP and 2-wire video-intercom modular boards are characterized by versatility and flexibility in order to create solution in different scenarios, from a home to a 500-apartment building.

Single Family Solution



7" IP Monitor
LCD Touch screen
Standard PoE connection
Log with lost calls



7" IP Monitor
LCD IPS Touch Screen
Standard PoE connection
Log with lost calls
Innovative Prized Design



IP Camera
Visualization from the monitor



7" 2-wire Monitor
LCD Touch Screen
2-wire power supply
Log with lost calls

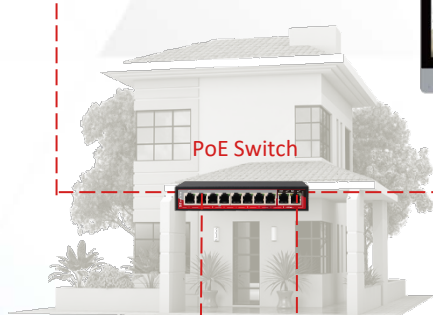

PoE Switch

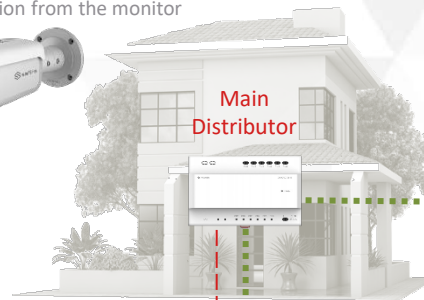

Main Distributor



INTERNET



IP Main Entrance
Fisheye camera
PoE Standard
One-touch call



2-wire Main Entrance
Fisheye camera
Card access
One-touch call

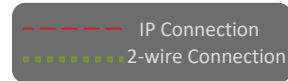

Building Solution

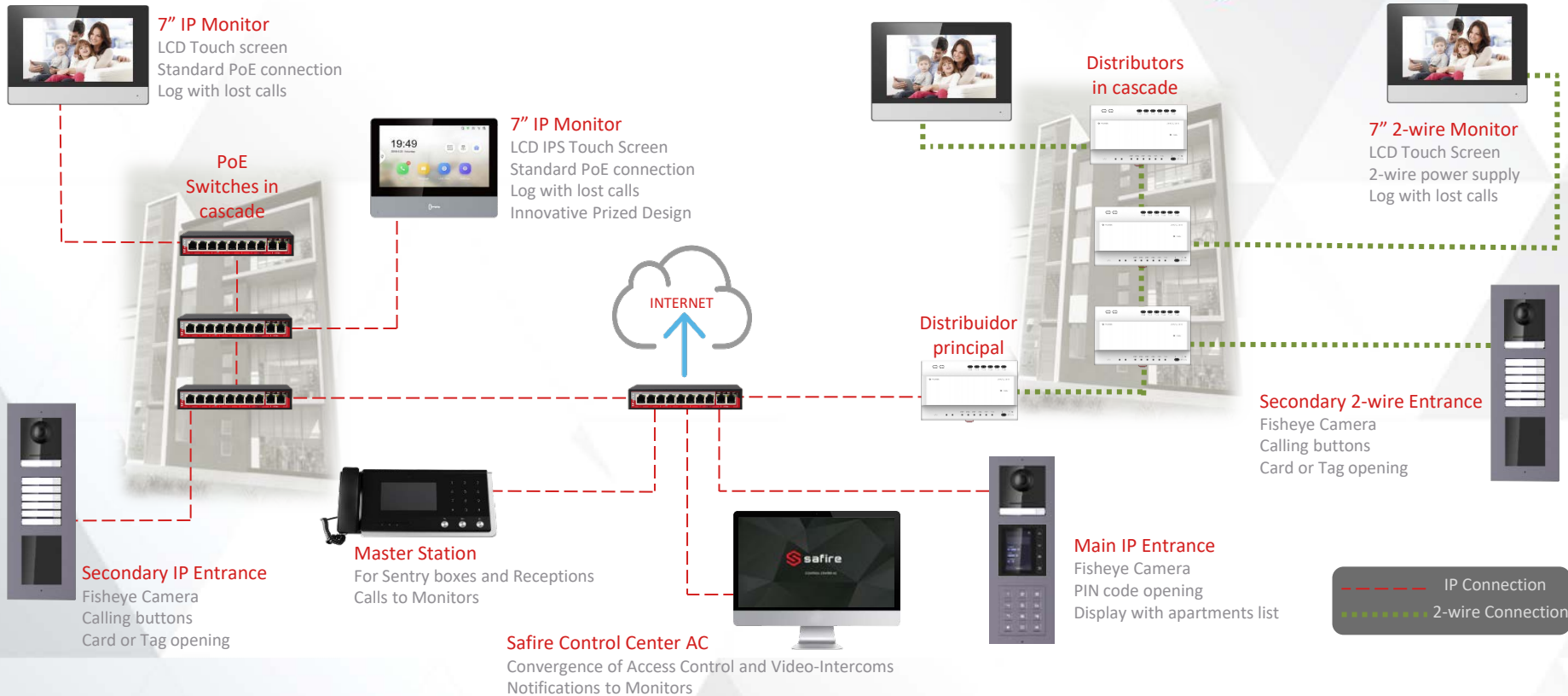

IP Solution

2-wire Solution

Product Lines



SF-VIMOD-CAM-IP-BF

- ✓ SF-VIMOD-CAM-IP
- ✓ Embedded mounting bracket



SF-VIMOD-CAM-IP-BS

- ✓ SF-VIMOD-CAM-IP
- ✓ Surface mounting bracket



SF-VIMOD-CAM-IP

- ✓ 2 Mpx IP65 Camera
- ✓ Backlit button
- ✓ Standard PoE



SF-VIMOD-CAM-2

- ✓ 2 Mpx IP65 Camera
- ✓ Backlit button
- ✓ 2-wire connection



SF-VIMOD-KEY6

- ✓ 6 backlit buttons
- ✓ Labels personalization



SF-VIMOD-KPAD

- ✓ Calls to residents
- ✓ PIN unlocking code
- ✓ IP65



SF-VIMOD-BLANK

- ✓ Filler Module
- ✓ IP65



SF-VIMOD-DIS

- ✓ List of Residents
- ✓ Door Status
- ✓ IP65



SF-VIMOD-CARD-EM(/MF*)

- ✓ Card Unlocking module
- ✓ 125KHz MHz / 13,56 MHz Mifare*
- ✓ IP65



SF-VIMOD-IND

- ✓ Call Status
- ✓ Door Status
- ✓ IP65

Product Lines



SF-VIDISP01-7WIP

- ✓ 7" TFT LCD
- ✓ Alarm Inputs
- ✓ PoE & WiFi Standards
- ✓ Micro SD card
- ✓ Safire Connect



SF-VIDISP02-7WIP

- ✓ 7" IPS LCD
- ✓ Easy opening button
- ✓ Alarm Inputs
- ✓ PoE & WiFi Standards
- ✓ Micro SD card
- ✓ Safire Connect



SF-VIDISP01-7IP

- ✓ 7" TFT LCD
- ✓ Alarm Inputs
- ✓ PoE Standard
- ✓ Micro SD card
- ✓ Safire Connect



SF-VIDISP01-10WIP

- ✓ 10" TFT LCD
- ✓ Alarm Inputs
- ✓ PoE & WiFi Standards
- ✓ Micro SD card
- ✓ Safire Connect



SF-VIDISP01-7W2

- ✓ 7" TFT LCD
- ✓ Alarm Inputs
- ✓ 2-wire & WiFi
- ✓ Micro SD card
- ✓ Safire Connect



SF-VI209M-IP

- ✓ 7" TFT LCD
- ✓ 0.3Mpx camera
- ✓ Alarm Inputs
- ✓ Master Monitor
- ✓ Micro SD card

Product Lines



SF-VIMOD-BS3

- ✓ Modular Bracket
- ✓ Up to 3 modules
- ✓ Surface mounting



SF-VIMOD-BS2

- ✓ Modular Bracket
- ✓ Up to 2 modules
- ✓ Surface mounting



SF-VIMOD-BS1

- ✓ Modular Bracket
- ✓ Up to 1 module
- ✓ Surface mounting



SF-VIMOD-BF1

- ✓ Modular Bracket
- ✓ Up to 1 module
- ✓ Embedded mounting



SF-VIMOD-BF2

- ✓ Modular Bracket
- ✓ Up to 2 modules
- ✓ Embedded mounting



SF-VIMOD-BF3

- ✓ Modular Bracket
- ✓ Up to 3 modules
- ✓ Embedded mounting



SF-VIB6320

- ✓ Desktop bracket
- ✓ Compatible with Monitors SF-VIDISP01

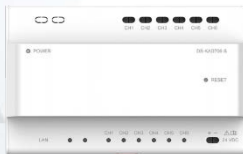

SF-VIMOD-HUB-2

- ✓ 2-wire to IP converter
- ✓ Up to 6 Hubs "M2" in cascade
- ✓ Brings net to other Hubs
- ✓ Surface or DIN



SF-VIMOD-HUB-M2

- ✓ 2-wire to IP converter
- ✓ Suitable for cascade
- ✓ Power supplies devices
- ✓ Surface or DIN

Product Lines



SF-VIK001-S-2

- ✓ SF-VIMOD-CAM-2
- ✓ SF-VIMOD-BS1
- ✓ SF-VIDISP01-7W2
- ✓ MicroSD Card included
- ✓ Hub 2Wire to IP
- ✓ 24V Power Adapter



SF-VIK001-F-IP

- ✓ SF-VIMOD-CAM-IP-FS
- ✓ SF-VIDISP01-7WIP
- ✓ Micro SD Card included
- ✓ Switch PoE included



SF-VIK001-S-IP

- ✓ SF-VIMOD-CAM-IP-BS
- ✓ SF-VIDISP01-7WIP
- ✓ MicroSD Card included
- ✓ Switch PoE included

Versatile and Modular Design

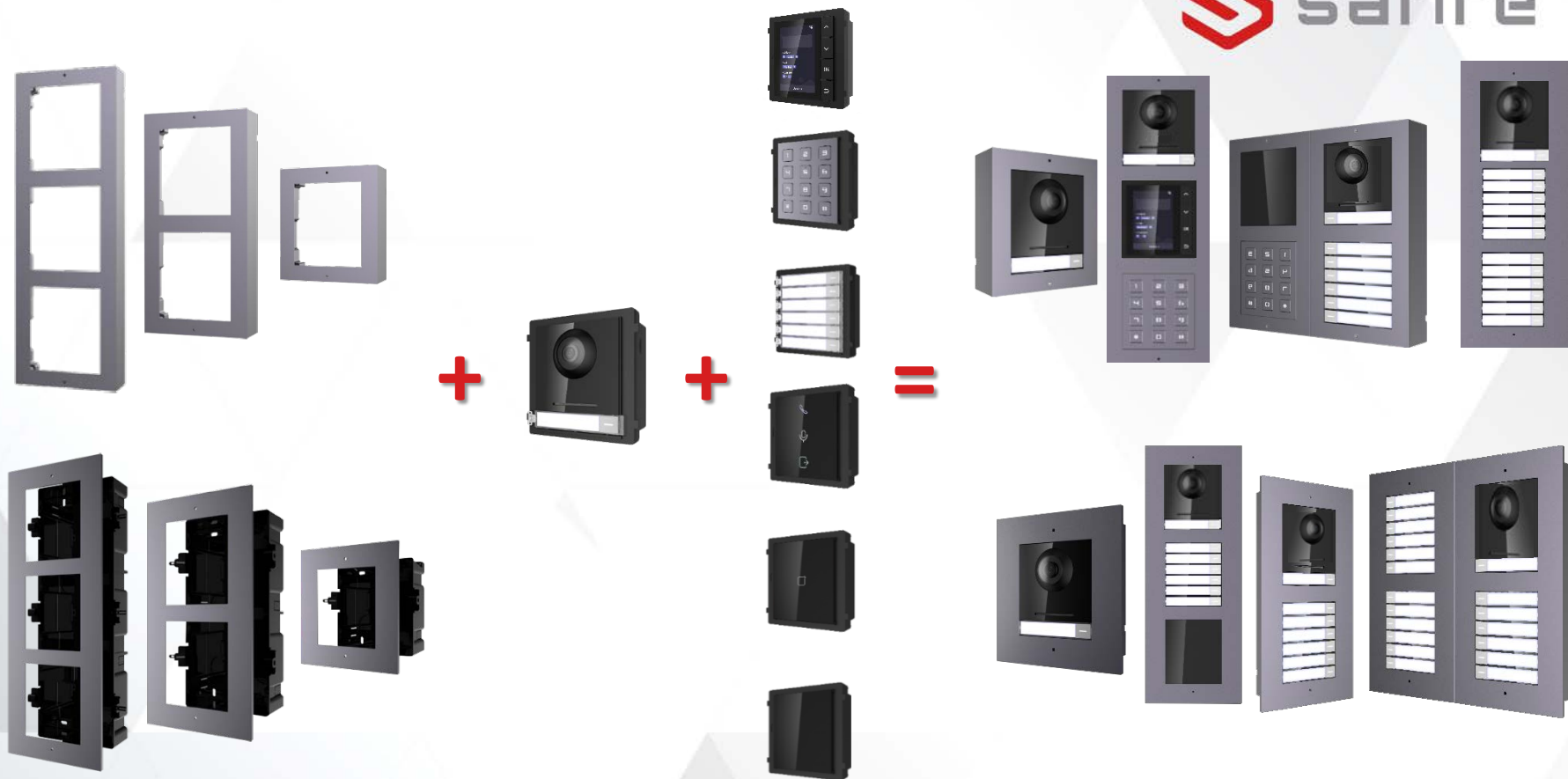

Transmission Distances



If board and monitor are powered by separate power supply sources

CABLE SPECS	18 AWG	20 AWG	24AWG
Monitors	50 m	30 m	15 m
Main module with 8 submodules	35 m	25 m	8 m

If board and monitor are powered by Standard PoE

CABLE SPECS	CAT 5	CAT 5E	CAT 6
Monitors	100 m	100 m	100 m
Main module with 8 submodules	60 m	80 m	100 m

2-wire Boards and Monitors with Hub

CABLE SPECS	24 AWG (0.2 mm ² , 9Ω/100 m) Twisted Pair	20 AWG (0.5 mm ² , 3.5Ω/100 m) Twisted Pair	18 AWG (0.8 mm ² , 9Ω/100 m) Twisted Pair	16 AWG (1.0 mm ² , 9Ω/100 m) Twisted Pair	24 AWG (0.2 mm ² , 9Ω/100 m) Parallel Lines	20 AWG (0.2 mm ² , 9Ω/100 m) Parallel Lines	18 AWG (0.2 mm ² , 9Ω/100 m) Parallel Lines	16 AWG (0.2 mm ² , 9Ω/100 m) Parallel Lines
Between Master and Slave Distributors	≤ 60 m	≤ 60 m	≤ 60 m	≤ 50 m	N/A	≤ 35 m	≤ 35 m	N/A
Between Master Distributors	≤ 60 m	≤ 60 m	≤ 60 m	≤ 50 m	N/A	≤ 35 m	≤ 35 m	N/A
Between Distributor and Board	≤ 35 m	≤ 60 m	≤ 60 m	≤ 50 m	N/A	≤ 35 m	≤ 35 m	N/A
Between Distributor and Monitor	≤ 35 m	≤ 100 m	≤ 100 m	≤ 100 m	≤ 100 m	≤ 100 m	≤ 100 m	≤ 100 m

Maximum 500 apartments | Each board button can call up to 6 monitors | Maximum 9 boards with the same configuration | Maximum 8 modules for each main board



safire
VIDEO INTERCOMS